

# FORCED STEERING PARTS

## forced drawbars K80 and frames

> **ZWL-KBA-KU**  
item no. 8004771



> **50-300**  
item no. 8002496



> **50-15-304**  
item no. 8004444



> **50-310**  
item no. 8002497



> **50-15-304W15**  
item no. 8004539



> **50-320**  
item no. 8002498



> **ZWL30KU-AS**  
item no. 8004824



> **ZWL30W15KU-AS**  
item no. 8004825



# FORCED STEERING PARTS

## for KB8309/KB8322/KB8335

> **50-15**  
item no. 8002213



## MOUNTING EXAMPLES



K80 up to 2x replaceable



series KU2000 with 360° free turnable pin

# WALTERSCHEID – YOUR PARTNER ON THE TRACTOR REAR

Hydraulic toplinks with original Walterscheid hook. The lower link hooks are operated from the safety of the driver's seat, while hydraulic lateral stabilizers provide safe and comfortable work in difficult terrain - these are only a few milestones in the world of coupling technology developed by Walterscheid within the last 30 years.

The integration of Walterscheid Cramer GmbH is another highlight and a big step forward on our track to bring more convenience and safety into the agricultural industry. A wide range of coupling ladders including different inserts, allows Walterscheid to become a full service provider for high quality coupling systems for tractors and self propelled equipment. Focusing on safe and convenient coupling systems makes Walterscheid the right partner for Original Equipment Manufacturers and farmers.

Walterscheid - we take agriculture forward!

# WALTERSCHEID

Australia

Walterscheid Australia  
17-31 Discovery Road  
Dandenong South, VIC, 3175

E: [walterscheid@walterscheid.com.au](mailto:walterscheid@walterscheid.com.au)  
W: [walterscheid.com.au](http://walterscheid.com.au)

## PH: 1300 WALTER

For more information and technical details please call our hotline or download the last version of the catalogue on [www.walterscheid.com.au](http://www.walterscheid.com.au)

WAS LAN-2020

We reserve the right to change without prior consultation. Use products only for the specified applications. We only guarantee constant quality. Reproduction, even in part, is only authorised with the written consent of Walterscheid Gm bH.

WALTERSCHEID

# WALTERSCHEID COUPLING SYSTEMS FOR LANDINI TRACTORS

Landini®

BAUREIHEN  
5830-10800  
Legend 105-180  
Mythos 90-115  
Powerfarm 60-105  
Powerful 230-280  
Rex 60-105

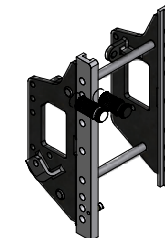

# FRAMES

## Series Legend 105-180

### > KU300

rail size W=335/30/22 mm – 7 H  
item no. 8002446



### > KU300KK

rail size W=335/30/22 mm – 6 H  
item no. 8004718



## Series Powerful 230-280

### > KU301ALX

rail size W=322/30/22 mm – 8 H  
item no. 8002733



### > KU301XKK

rail size W=322/30/22 mm – 5 H  
item no. 8002735



## Series Mythos 90-115

### > KU351

rail size W=309/30/22 mm – 7 H  
item no. 8002449



## Series Rex 60-105/Powerfarm 60-105

### > KU352

rail size W=309/30/22 mm – 6 H  
item no. 8002450



newest flexing-technology and modular design  
for flexible part design



# ADJUSTABLE MODELS

reference	rail size (mm)	item no.
KU2000/309NB	309/30/22	8004187
KU2000/322NB	322/30/22	8004191
KU2000/335NB	335/30/22	8004182



37mm spherical

KU5410/309	309/30/22	8003697
KU5410/322	322/30/22	8003698
KU5410/335	335/30/22	8003700



31mm cylindrical

KU2000/309NA5	309/30/22	8004185
KU2000/322NA5	322/30/22	8004189
KU2000/335NA5	335/30/22	8004284



32mm cylindrical

KB8309	309/30/22	8002576
KB8322	322/30/22	8002578
KB8335	335/30/22	8002580



KI8309	309/30/22	8002585
KI8322	322/30/22	8002588
KI8335	335/30/22	8002590



PB5309N	309/30/22	8003245
PB5322N	322/30/22	8003247
PB5335N	335/30/22	8003249

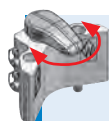

forged tool-free downholder for compensation  
of high negative charges

360° for free turnable for free sight  
forged catch device with centering function



# DRAWBARS WITH BALL

## Series Powerful 230-280

### > KBA8301ALX

straight  
item no. 8003679



## MORE MODELS

## Series Rex 60-105

### > KU876/94008

automatic 38mm  
item no. 8004032



## Series 5830-10800

### > KU835

manual pin  
item no. 8002465



Walterscheid couplings are made from  
forged parts design for heavy duty conditions.

