

Document No:	SABRECAT
Issue:	3
Issue Date:	03/03/2021

This catalogue is the copyright of HS Company Pty Ltd

## COMPETITOR COMPARISON GUIDE

### Standard Range

Sabre	Hardy Spicer	Bypy	Walterscheid	Bareco
T10		101	W2100	1
T20	1140	102	W2200	2
T40	1310	104	W2300	4
T60	1350	106	W2400	6
T80	1480	108	W2500	8
T90		109	W2600	9

### Heavy Duty Range

Sabre	Comer	Bypy	Walterscheid	Bareco
AGC2400	V60	406	P400	W2400
AGC2500	V80	408	P500	W2500
AGC2600	V90	409	P600	W2600

### Wide Angle Range

#### Wide Angle Shafts (1 x CVJ)

Sabre	Comer	Bypy	Walterscheid	Bareco
	T20 or V20-CV	652 or 662	WWE2280	
	T40 or V40-CV	654 or 664	WWE2380	WB4
AGC2480	T60 or V60-CV	656 or 666	WWE2480	WB6
AGC2580	T80 or V80-CV	658 or 668	WWE2580	

#### Wide Angle Shafts (2 x CVJ)

Sabre	Comer	Bypy	Walterscheid	Bareco
	T20 or V20-2CV	672	WWZ2280	
	T40 or V40-2CV	674	WWZ2380	
	T60 or V60-2CV	676	WWZ2480	WB6
	T80 or V80-2CV	678	WWZ2580	

NOTE: 1. These comparisons are for ratings only. Parts are not interchangeable between all sizes.

Document No:	SABRECAT
Issue:	3
Issue Date:	03/03/2021

This catalogue is the copyright  
of HS Company Pty Ltd

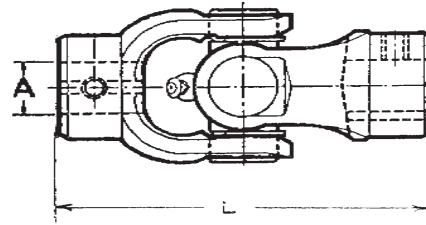

### 1000 SERIES SINGLE JOINT ASSEMBLY

Part Number	Hole Dia A	Key	Hub O.D.	Length L	Length Thru Hole	Angle	Comments
SKA-10750	19.05	4.78	41.28	127.00	27.00	60	
	0.750	0.188	1.625	5.000	1.063		
SKA-10875	22.23	6.35	41.28	127.00	27.00	60	
	0.875	0.250	1.625	5.000	1.063		
SKA-10100	25.40	6.35	41.28	127.00	27.00	60	
	1.000	0.250	1.625	5.000	1.063		
SKA-10250M	25.00	8.00	41.28	127.00	27.00	60	
	0.984	0.315	1.625	5.000	1.063		

### 1AGS SERIES SINGLE JOINT ASSEMBLY

Part Number	Hole Dia A	Key	Hub O.D.	Length L	Length Thru Hole	Angle	Comments
1AGS-YM-YM-3/4	19.05	4.78	47.50	127.00	27.00	60	
	0.750	0.188	1.870	5.000	1.063		
1AGS-YM-YM-7/8	22.23	4.78	47.50	127.00	27.00	60	
	0.875	0.188	1.870	5.000	1.063		
1AGS-YM-YM-3	25.40	6.35	47.50	127.00	27.00	60	
	1.000	0.250	1.870	5.000	1.063		
1AGS-YM-YM-25	25.00	8.00	47.50	127.00	27.00	60	
	0.984	0.315	1.870	5.000	1.063		

Note: More options and configurations in 1AGS series are available on request, contact your local branch for more information.

Document No:	SABRECAT
Issue:	3
Issue Date:	03/03/2021

This catalogue is the copyright of HS Company Pty Ltd

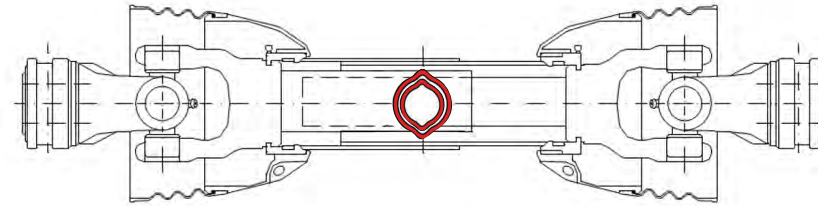

### AG SERIES COMPLETE SHAFTS

Series	Horsepower Ratings		Length C - C of U/Joints		COMPLETE SHAFTS			
	@ 540 RPM	@ 1000 RPM	Compressed mm	Extended mm	1 3/8 x 6 QR Both Ends (Collar Type)	1 3/8 x 6 QR One End Only (Collar Type)	No End Yokes	Notes
<b>AG1</b>	16HP / 12kW	25HP / 18kW	510mm	710mm	<b>AG1-510-SC2</b>	<b>AG1-510-SC1</b>		
			1010mm	1450mm	<b>AG1-1010-SC2</b>	<b>AG1-1010-SC1</b>		
<b>AG2</b>	27HP / 20kW	42hp / 31kW	1010mm	1450mm	<b>AG2-1010-SC2</b>	<b>AG2-1010-SC1</b>		
			1510mm	1950mm	<b>AG2-1510-SC2</b>	<b>AG2-1510-SC1</b>		
<b>AG3</b>	38HP / 28kW	60HP / 45kW	1010mm	1410mm	<b>AG3-1010-SC2</b>	<b>AG3-1010-SC1</b>		Uses 0v/1 Tube
			1510mm	1910mm	<b>AG3-1510-SC2</b>	<b>AG3-1510-SC1</b>		Uses 0v/1 Tube
<b>AG3H</b>	38HP / 28kW	60HP / 45kW	1010mm	1410mm	<b>AG3H-1010-SC2</b>	<b>AG3H-1010-SC1</b>		Uses 1b/2a Tube
			1510mm	1910mm	<b>AG3H-1510-SC2</b>	<b>AG3H-1510-SC1</b>		Uses 1b/2a Tube
<b>AG4</b>	64HP / 47kW	100HP / 74kW	1010mm	1410mm	<b>AG4-1010-SC2</b>	<b>AG4-1010-SC1</b>		
			1510mm	1910mm	<b>AG4-1510-SC2</b>	<b>AG4-1510-SC1</b>		
<b>AG5</b>	90HP / 67kW	139HP / 103kW	1210mm	1610mm	<b>AG5-1210-SC2</b>	<b>AG5-1210-SC1</b>		Uses Star Tube S4 / S5

Document No:	SABRECAT
Issue:	3
Issue Date:	03/03/2021

This catalogue is the copyright  
of HS Company Pty Ltd

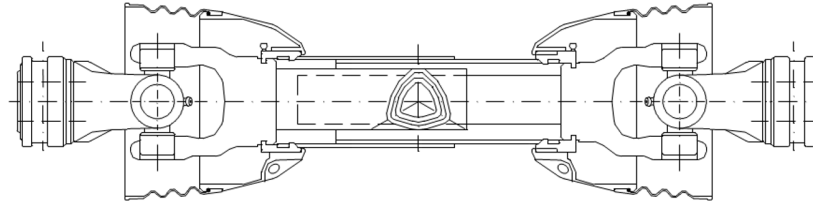

## 'T' SERIES COMPLETE SHAFTS

Series	Horsepower Ratings		Length C - C of U/Joints		COMPLETE SHAFTS			
	@ 540 RPM	@ 1000 RPM	Compressed mm	Extended mm	1 3/8 x 6 QR (Pin Type) Both Ends	1 3/8 x 6 QR (Pin Type) One End Only	No End Yokes	
<b>T10</b>	16HP / 12kW	25HP / 18kW	1010mm	1450mm	<b>T10-1010F112112</b>	<b>T10-1010F112000</b>	<b>T10-1010F000000</b>	
<b>T20</b>	21HP / 15kW	31hp / 23kW	1010mm	1450mm	<b>T20-1010F112112</b>	<b>T20-1010F112000</b>	<b>T20-1010F000000</b>	
			1510mm	1950mm	<b>T20-1510F112112</b>	<b>T20-1510F112000</b>	<b>T20-1510F000000</b>	
<b>T40</b>	35HP / 26kW	55HP / 40kW	1010mm	1410mm	<b>T40-1010F112112</b>	<b>T40-1010F112000</b>	<b>T40-1010F000000</b>	
			1510mm	1910mm	<b>T40-1510F112112</b>	<b>T40-1510F112000</b>	<b>T40-1510F000000</b>	
<b>T60</b>	64HP / 47kW	100HP / 74kW	1010mm	1410mm	<b>T60-1010F112112</b>	<b>T60-1010F112000</b>	<b>T60-1010F000000</b>	
			1510mm	1910mm	<b>T60-1510F112112</b>	<b>T60-1510F112000</b>	<b>T60-1510F000000</b>	
<b>T80</b>	95HP / 70kW	150HP / 110kW	1010mm	1410mm	<b>T80-1010F112112</b>	<b>T80-1010F112000</b>	<b>T80-1010F000000</b>	<b>T80-1010F112100</b> <i>1 3/8 x 6 QR + Flange to suit Howard Friction Clutch</i>
			1510mm	1910mm	<b>T80-1510F112112</b>	<b>T80-1510F112000</b>	<b>T80-1510F000000</b>	

Document No:	SABRECAT
Issue:	3
Issue Date:	03/03/2021

This catalogue is the copyright of HS Company Pty Ltd

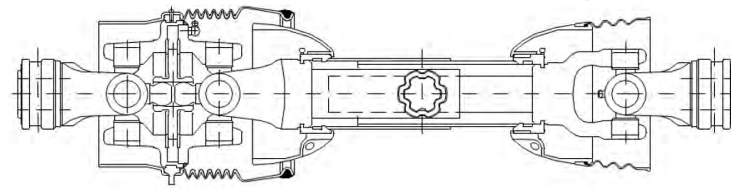
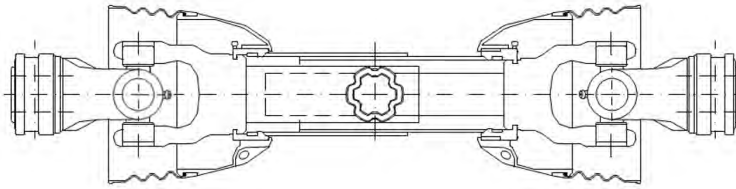

### 'V' SERIES COMPLETE SHAFTS

Series	Horsepower Ratings		Length C - C of U/Joints		COMPLETE SHAFTS		WIDE ANGLE COMPLETE SHAFTS	
	@ 540 RPM	@ 1000 RPM	Compressed mm	Extended mm	1 3/8 x 6 QR (Collar Type) Both Ends		1 3/8 x 6 QR (Collar Type) Both Ends	
<b>V60</b>	67HP / 50kW	103HP / 77kW	1010mm	1410mm	<b>V601010ENC12C12</b>		<b>V601010ENCVC12</b>	
			1510mm	1910mm	<b>V601510ENC12C12</b>		<b>V601510ENCVC12</b>	
<b>V80</b>	99HP / 74kW	151HP / 113kW	1010mm	1510mm	<b>V801010ENC12C12</b>		<b>V801010ENCVC12#</b>	
			1510mm	2010mm	<b>V801510ENC12C12</b>		<b>V801510ENCVC12</b>	
<b>V90</b>	118HP / 88kW	188HP / 140kW	1010mm	1480mm	<b>V901010ENC12C12</b>			
			1510mm	2010mm	<b>V901510ENC12C12#</b>			

Document No:	SABRECAT
Issue:	3
Issue Date:	03/03/2021

This catalogue is the copyright  
of HS Company Pty Ltd

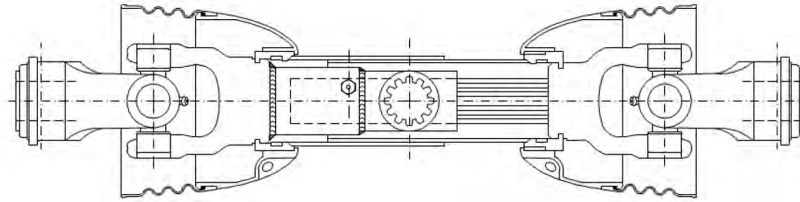

### 'D' SERIES COMPLETE SHAFTS

Series	Horsepower Ratings		Length C - C of U/Joints		COMPLETE SHAFTS		
	@ 540 RPM	@ 1000 RPM	Compressed mm	Extended mm	1 3/4 x 20 QR On One End Only		
<b>D120</b>	196HP / 144kW	300hp / 221kW	1010mm	1650mm	<b>D121010ENC25000</b>		

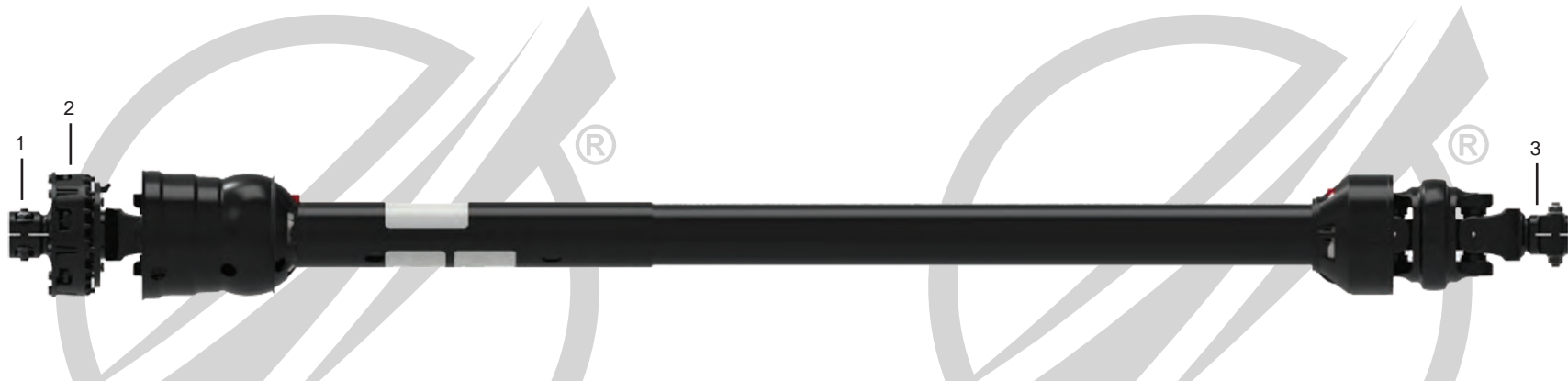

### Complete Double 50° CV PTO Shaft with Friction Overrun Clutch

Series	Length C - C of U/Joints	Horsepower Ratings		50° CV Clutch Yoke 1 3/8 x 21Spl Clamp Bolt	Clutch Pack	50° CV Yoke 1 3/8 x 21Spl Clamp Bolt	Complete Shaft Part Number
	Compressed mm	@ 540 RPM	@ 1000 RPM	1 <i>Clutch Yoke Only</i>	2 <i>Clutch Pack Only</i>	3 <i>End Yoke Only</i>	1 3/8 x 21Spl CB 1 3/8 x 21Spl CB
<b>5550</b>	1917mm	117HP / 87kW	179HP / 134kW	<b>55-38-60222</b>	<b>57112000</b>	<b>55-857-5521</b>	<b>55-14605589</b>

Note: Clutch pack # 57112000 utilizes M10 mounting holes. The four flange holes on the CV clutch yoke are 5/16".  
To accommodate clutch pack # 57112000, the flange holes need to be drilled out to suit 10mm bolts.

Note: Other end yokes are available on request.

# INDENT ITEM ONLY

Document No:	SABRECAT
Issue:	3
Issue Date:	03/03/2021

This catalogue is the copyright of HS Company Pty Ltd

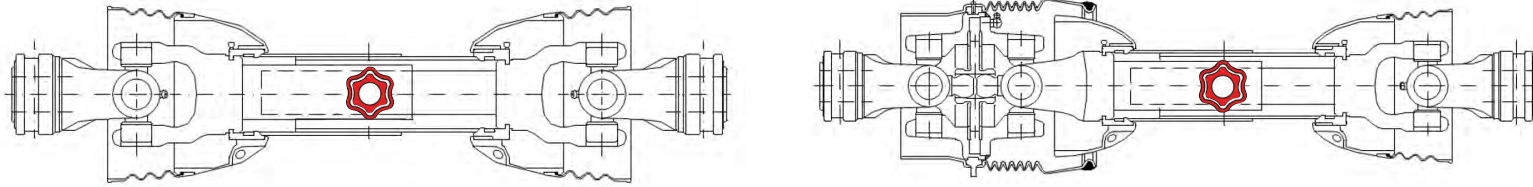

### 'AGC' SERIES COMPLETE SHAFTS

Series	Horsepower Ratings				Length C - C of U/Joints		COMPLETE SHAFTS	80° WIDE ANGLE COMPLETE SHAFTS		NOTES
	@ 540 RPM		@ 1000 RPM		Compressed mm	Extended mm	No Yokes Fitted	1 3/8 x 6 QR Both Ends		
	HP	kW	HP	kW						
<b>AGC2400</b>	64	47	100	74	1010mm	1410mm	<b>AGC2400-SS-101</b>		<b>Star Profile</b>	
					1510mm	1910mm	<b>AGC2400-SS-151</b>		<b>Star Profile</b>	
<b>AGC2500</b>	110	82	150	112	1010mm	1410mm	<b>AGC2500-SS-101</b>		<b>Star Profile</b>	
					1510mm	1910mm	<b>AGC2500-SS-151</b>		<b>Star Profile</b>	
<b>AGC2600</b>	120	90	166	124	1010mm	1380mm	<b>AGC2600-SS-101</b>		<b>Star Profile</b>	
					1410mm	1780mm	<b>AGC2600-SS-141</b>		<b>Star Profile</b>	
<b>AGC2480</b>	64	48	99	74	1210mm	1575mm		<b>AGC2480-TT-121</b>	<b>Triangular Profile</b>	<b>Rear UJ T60 Series</b>
<b>AGC2580</b>	90	67	139	104	1210mm	1550mm		<b>AGC2580-SS-121</b>	<b>Star Profile</b>	<b>Rear UJ T80 Series</b>
					1510mm	1850mm		<b>AGC2580-SS-151</b>	<b>Star Profile</b>	<b>Rear UJ T80 Series</b>

A selection of AGC Series Yokes and Clutches are available in the relevant sections of the Walterscheid DLS and Sabre AG catalogues.

Note: Other end yokes are available on request.