

HYDRAULIC LIFT LINK

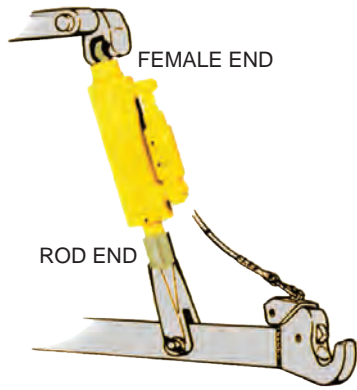

Cat	Length	Part Number
Cat 3	430 - 585	306222
(Supplied with screw on Weldable Ends & Loctite)		
Rod end	M36x3	306215
Female end	M33X2	306216
Cat	Dia - Length	Part Number
Shank	M36x3	306022
Nut	M36x3	306373
Roll Pin	6x45	61.04.01

HYDRAULIC SIDE SHIFT

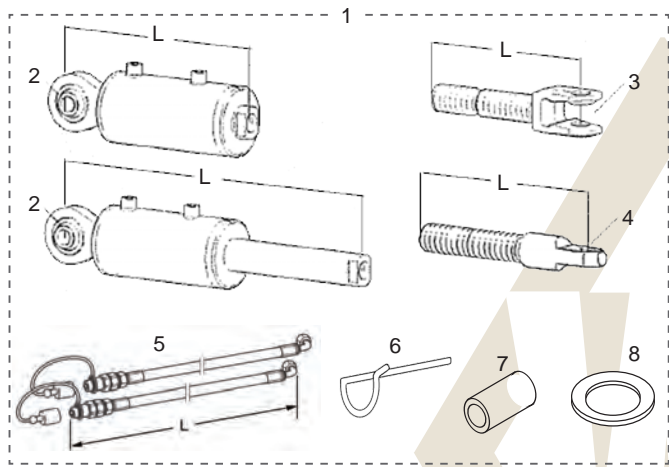

Ref	Description	L / size (mm)	Part Number
1	Hyd. Side Shift Complete Kit (Max Working Length 420 - 650)	310	203508
	Hyd. Side Shift Complete Kit (Max Working Length 650 - 900)	340	203509
2	Hyd Cylinder	310	203060
	Hyd Cylinder	340	203485
3	Fork Rod	370	203495
4	Rod Head	370	203497
5	Hyd Hose Kit	1500	203498
6	Lock Spring	-	203496
7	Adapter bush Cat 2-1	-	082649
8	Spacer Washer	26x44x4	200647
		21x37x2	309253

Hydraulically Adjustable Stabilizer HVST

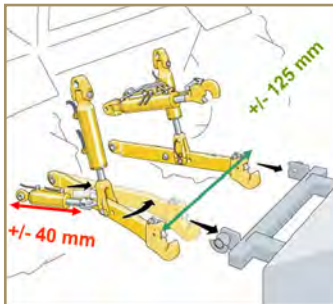

The Hydraulically adjustable stabilizer gives the opportunity to side shift the complete 3 point linkage including any implement laterally up to +/- 250mm.

Therefore as an example for front and rear mower combination results in:

- Much better overlapping during curved driving
- Much better overlapping at slope mowing (anti-shift)
- Much better adjusting of implements along obstacles.

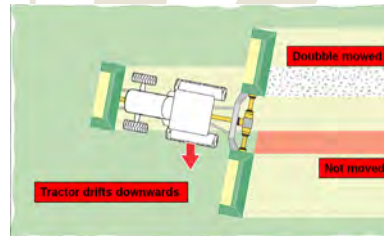

Example: Slope moving without any anti-drift system.

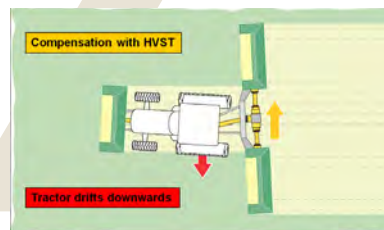

Example: Slope moving with the hydraulically adjustable stabilizer HVST



Function:

The hydraulically adjustable stabilizer allows the following lateral movement (side-shift):
 Stabilizer: +/- 40mm*
 Lower Link: +/- 125mm*
 Implement: +/- 250mm*

The HVST is installed into the same area as our market leading automatic stabilizer the ASST-B. The hydraulics are connected to and operated by a double acting SCV.

