

FM TYPE FRICTION DISC CLUTCH

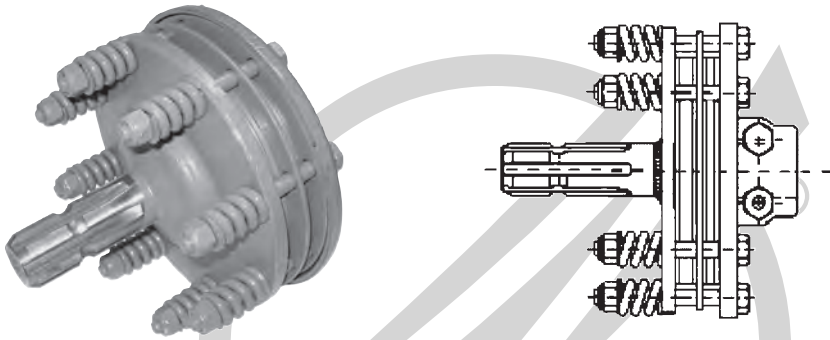

Ratings			Male Spline Details	F/Male Spline Details	Complete Unit Part Number	Length E-E		OD	
540 RPM	1000 RPM	Torque				mm	inch	mm	inch
50 Hp	90 Hp	480 ft.lb 650 Nm	1 3/8" x 6	1 3/8" x 6	FM-231-003	189	7.441	150	5.905
				1 3/8" x 21					
65 Hp	125 Hp	665 ft.lb 900 Nm	1 3/8" x 6	1 3/8" x 6	FM-241-006	207	8.149	180	7.086
				1 3/8" x 21					
90 Hp	165 Hp	885 ft.lb 1500 Nm	1 3/8" x 6	1 3/8" x 6	FM-252-009	209	8.228	180	7.086
				1 3/8" x 21					
120 Hp	188 Hp	1475 ft.lb 2400 Nm	1 3/8" x 6	1 3/8" x 6	FM-264-005	209	8.228	200	7.874
				1 3/8" x 21					
			1 3/4" x 6	1 3/4" x 6	FM-284-001				
			1 3/4" x 20	1 3/4" x 20	FM-284-002				

European PTO

# INDENT ITEM ONLY

B:7-46

www.walterscheid.com.au

Document No:	SABRECAT
Issue:	1
Issue Date:	20/04/2019

This catalogue is the copyright of HS Company Pty Ltd

**FM TYPE FRICTION DISC CLUTCH**

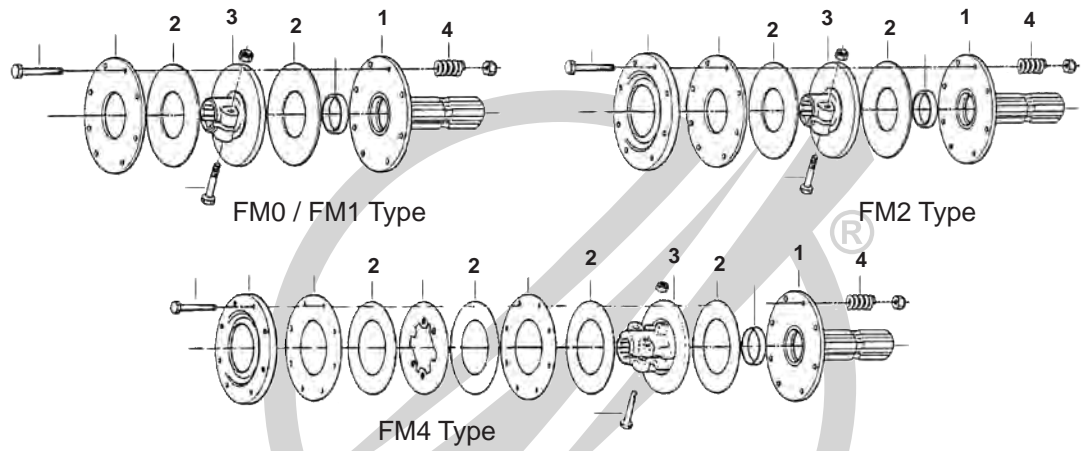

Series	Ref.	Male shaft Face	Clutch Lining	Lining Dia. mm		Hub	Spring
		1	2	OD	ID	3	4
2	FM02	F02-013-051#	F02-014-019	120	68	F02-014-018#	F12-014-022
						F02-013-022#	
4	FM12	F12-013-055#	F12-015-019	142	77.5	F12-015-018#	F12-014-022
						F12-015-010#	
6	FM22	F22-019-060#	F42-019-018	152	90	F22-018-018#	F22-019-017
						F22-017-013#	
8	FM42	F42-019-060#	F42-019-018	152	90	F42-019-011#	F12-014-022
						F42-019-008#	
						F42-019-012#	
						F42-019-009	

Call Walterscheid Australia for further details on clutch spare parts

www.walterscheid.com.au



Document No:	SABRECAT
Issue:	1
Issue Date:	20/04/2019

This catalogue is the copyright of HS Company Pty Ltd

# INDENT ITEM ONLY

## F TYPE FRICTION DISC CLUTCH

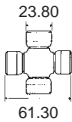
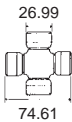
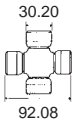
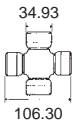

Series	U/Joint Size	Ref.	Spline Details	Part Number	Maximum Torque		Length C-E		OD	
					Nm	in.lb	mm	inch	mm	inch
2		F02	1 3/8" x 6	<b>T20-221-001</b>	650	5750	120	4.724	153	6.024
		F03	1 3/8" x 21	<b>T20-221-002#</b>						
4		F02	1 3/8" x 6	<b>T40-241-002</b>	900	7950	135	5.315	180	7.086
		F12	1 3/8" x 6	<b>T40-241-001</b>						
		F13	1 3/8" x 21	<b>T40-241-003#</b>						
6		F22	1 3/8" x 6	<b>T60-261-001</b>	1200	10620	146	5.748	195	7.677
		F42	1 3/8" x 6	<b>T60-264-001</b>	1600	14150	156	6.142		
8		F42	1 3/8" x 6	<b>T80-284-001</b>	2000	17700	169	6.654	195	7.677
		F44	1 3/4" x 6	<b>T80-284-013</b>						
		F45	1 3/4" x 20	<b>T80-284-004</b>						
9		F42	1 3/8" x 6	<b>T90-294-011</b>	2000	17700	169	6.654	195	7.677
		F44	1 3/4" x 6	<b>T90-294-013#</b>						
		F45	1 3/4" x 20	<b>T90-294-014#</b>						

European PTO

# INDENT ITEM ONLY

B:7-48

www.walterscheid.com.au

Document No:	SABRECAT
Issue:	1
Issue Date:	20/04/2019

This catalogue is the copyright of HS Company Pty Ltd

European PTO

**F TYPE FRICTION DISC CLUTCH**

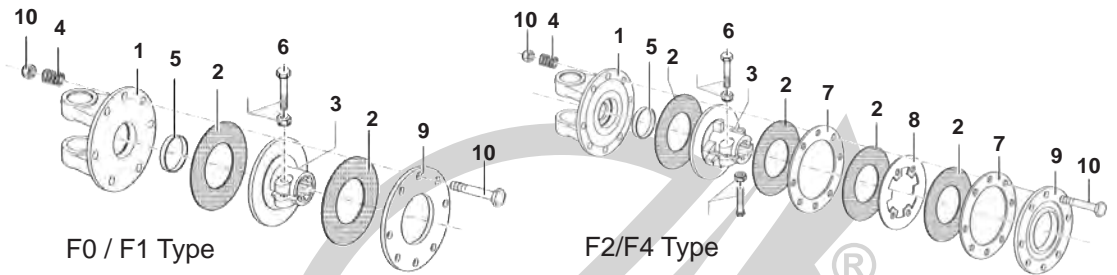

Components suit original Comer clutches only.

Series	Ref.	Flange Yoke 1	Clutch Lining 2	Lining Dia. mm OD / ID		Hub 3	Spring 4
2	F02	T20-012-139#	F02-014-019	120	68	F02-014-570#	F12-014-022
	F03					F02-014-592#	
4	F02	T40-014-017#	F02-014-019	120	68	F02-014-570#	F12-014-022
	F12	T40-014-009	F12-015-019	142	77.5	F12-015-018	F12-014-022
	F13					F12-015-010#	
6	F22	T60-016-037	F42-019-018	152	90	F22-018-018	F12-014-017
	F42	T60-016-037	F42-019-018	152	90	F42-019-011	F12-014-017
8	F42	T80-018-016	F42-019-018	152	90	F42-019-011	F12-014-022
	F44					F42-019-012	
	F45					F42-019-009	
9	F42	T90-019-059#	F42-019-018	152	90	F42-019-011	F12-014-022
	F44					F42-019-012	
	F45					F42-019-009	

**EXTRA INTERNAL SPARE PARTS FOR DISC CLUTCHES**

Clutch Type	Bush 5	Bolt Kit 6	Inner Plate 7	Intermediate Plate 8	Pressure Plate 9	Bolt Kit 10
F0 / F1	F12-015-020	165-000-502 <i>suit 1-3/8" spl hubs</i>			F12-015-021	165-000-501
F2 / F4	F42-019-019	165-000-502 <i>suit 1-3/8" spl hubs</i>	F42-019-014	F42-019-115	F42-019-116	165-000-548
		165-000-503 <i>suit 1-3/4" spl hubs</i>				

www.walterscheid.com.au

Document No:	SABRECAT
Issue:	1
Issue Date:	20/04/2019

This catalogue is the copyright of HS Company Pty Ltd

Call Walterscheid Australia for further details on clutch spare parts

# INDENT ITEM ONLY

**SHEAR BOLT TORQUE LIMITER**

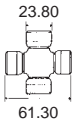
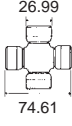
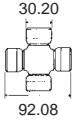
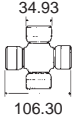
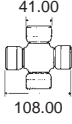

Series	U/Joint Size	Ref.	Splines Details	Part Number	Maximum Torque		Length C-E	
					Nm	in.lb	mm	inch
2	 23.80 61.30	B02	1 3/8" x 6	T20-220-001#	650	5700	95	3.740
		B03	1 3/8" x 21	T20-220-002#				
4	 26.99 74.61	B02	1 3/8" x 6	T40-240-001#	1700	15000	97	3.819
		B03	1 3/8" x 21	T40-240-002#				
6	 30.20 92.08	B02	1 3/8" x 6	T60-260-001	2500	22100	137	5.394
		B03	1 3/8" x 21	T60-260-003#				
		B04	1 3/4" x 6	T60-260-002#				
		B05	1 3/4" x 20	T60-260-004#				
8	 34.93 106.30	B02	1 3/8" x 6	T80-280-001	3500	30900	146	5.748
		B03	1 3/8" x 21	T80-280-003#				
		B04	1 3/4" x 6	T80-280-002#				
		B05	1 3/4" x 20	T80-280-004				
9	 41.00 108.00	B02	1 3/8" x 6	T90-290-001#	4000	35400	152	5.984
		B03	1 3/8" x 21	T90-290-003#				
		B04	1 3/4" x 6	T90-290-002#				
		B05	1 3/4" x 20	T90-290-004#				

European PTO

# INDENT ITEM ONLY

B:7-50

www.walterscheid.com.au

Document No:	SABRECAT
Issue:	1
Issue Date:	20/04/2019

This catalogue is the copyright of HS Company Pty Ltd

European PTO

**SHEAR BOLT TORQUE LIMITER PARTS**

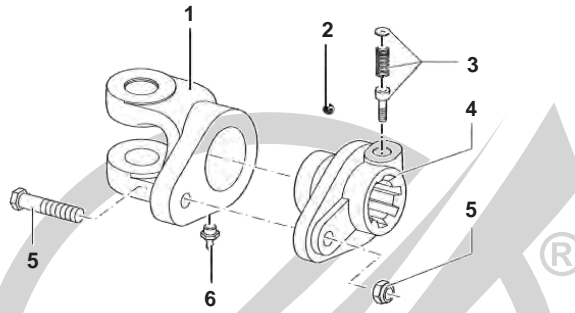

Series	Ref.	Yoke 1	Ball 2	QR Push Pin Set 3	Splined Hub 4	Bolt & Nut 5	Grease Nipple 6
<b>2</b>	B02	T20-012-005#	190-000-024# 7/32" DIA (24 Req)	165-026-004	T20-022-010#	165-000-509# M6x40 (ISO 8.8)	M8x1
	B03				T20-022-017#		
<b>4</b>	B02	T40-014-012#	190-000-022# 1/4" DIA (23 Req)	165-026-004	T40-024-013#	165-000-505# M8x50 (ISO 8.8)	M8x1
	B03				T40-024-026#		
<b>6</b>	B02	T60-016-042#	190-000-023# 5/16" DIA (24 Req)	165-026-004	T60-026-043#	165-000-507# M10x60 (ISO 8.8)	M10x1
	B03				T60-026-026#		
	B04			166-026-005	T60-026-044#		
	B05				T60-026-027#		
<b>8</b>	B02	T80-018-023#	190-000-023# 5/16" DIA (24 Req)	165-026-004	T80-028-024#	165-000-512# M12x65 (ISO 8.8)	M10x1
	B03				T80-028-037#		
	B04			166-026-005	T80-028-025#		
	B05				T80-028-038#		
<b>9</b>	B02	T90-019-136#	190-000-023# 5/16" DIA (24 Req)	165-026-004	T90-029-137#	165-000-512# M12x65 (ISO 8.8)	M10x1
	B03				T90-029-142#		
	B04			166-026-005	T90-029-141#		
	B05				T90-029-140#		

www.walterscheid.com.au



Document No:	SABRECAT
Issue:	1
Issue Date:	20/04/2019

This catalogue is the copyright of HS Company Pty Ltd

# INDENT ITEM ONLY

OVERLOAD RATCHET CLUTCHES

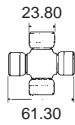
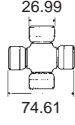

Series	U/Joint Size	Ref.	Spline Details	Part Number	Maximum Torque		Length C-E	
					Nm	in.lb	mm	inch
2	 23.80 61.30	U24	1 3/8" x 6	T20-226-001	600	5310	146	5.748
4	 26.99 74.61	U34	1 3/8" x 6	T40-246-001	900	7965	185	7.283
6	 30.20 92.08	U44	1 3/8" x 6	T60-266-029	1200	10620	220	8.66

European PTO

# INDENT ITEM ONLY

B:7-52

www.walterscheid.com.au

Document No:	SABRECAT
Issue:	1
Issue Date:	20/04/2019

This catalogue is the copyright of HS Company Pty Ltd

European PTO

OVERRUNNING CLUTCH

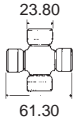
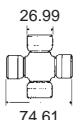
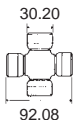
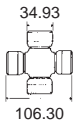

Series	U/Joint Size	Ref.	Splines Details	Part Number	Maximum Torque		Length C-E	
					Nm	in.lb	mm	inch
2		R12	1 3/8" x 6	T20-225-001#	3800	33630	146	5.748
		R13	1 3/8" x 21	T20-225-002#				
4		R12	1 3/8" x 6	T40-245-001	3800	33630	157	6.181
6		R12	1 3/8" x 6	T60-265-001	3800	33630	167	6.575
		R13	1 3/8" x 21	T60-265-004	3800	33630	167	6.575
8		R12	1 3/8" x 6	T80-285-001	3800	33630	176	6.929
		R13	1 3/8" x 21	T80-285-002	3800	33630	176	6.929

Call Walterscheid Australia for further details on overrunning clutch spare parts

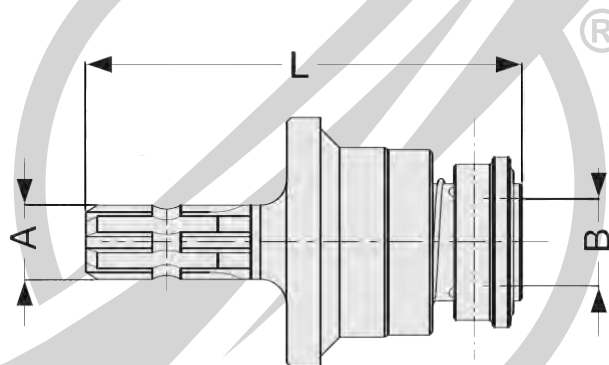

Ref	Splines Details A (Male)	Splines Details B (Female)	Part Number	Maximum Torque		Length L	
				Nm	in.lb	mm	inch
RM	1 3/8" x 6	1 3/8" x 6	RM-215-015	3800	33630	208	8.188

# INDENT ITEM ONLY

www.walterscheid.com.au	
Document No:	SABRECAT
Issue:	1
Issue Date:	20/04/2019

This catalogue is the copyright of HS Company Pty Ltd